

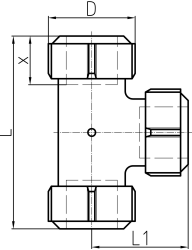

**Tee, galvanised
equal, for ISO 65 Steel pipe**

- Articles with EPDM-seals are discontinued items and available as long as our stock will last.



Dim. (inch)	NBR Code	EPDM Code	FPM Code	SP	GP	Weight (kg)	D (mm)	L (mm)	L1 (mm)	x (mm)
3/8	775 302 050			1	5	0.450	45	110	55	30 - 34
1/2	775 302 051	775 306 051	775 308 051	1	5	0.520	45	110	55	30 - 34
3/4	775 302 052	775 306 052	775 308 052	1	5	0.660	51	115	58	30 - 34
1	775 302 053	775 306 053	775 308 053	1	5	0.880	59	121	61	30 - 34
1 1/4	775 302 054		775 308 054	1	5	1.260	68	130	65	30 - 36
1 1/2	775 302 055	775 306 055	775 308 055	1	5	1.400	75	144	72	32 - 38
2	775 302 056	775 306 056	775 308 056	1	5	2.720	96	166	83	36 - 42

The technical data are not binding. They neither constitute expressly warranted characteristics nor guaranteed properties nor a guaranteed durability. They are subject to modification. Our General Terms of Sale apply.

Georg Fischer Piping Systems Ltd, Postfach, CH-8201 Schaffhausen/Switzerland

Phone +41 -(0)52-631 1111

e-mail: info.ps@georgfischer.com

Internet: <http://www.gfps.com>